

107 Redfern Street Access Map

Key

Watch your step

Access ramp

Unisex toilet

Female toilet

Male toilet

Unisex accessible toilet

Baby change facilities

Lift

Stairs

First Aid (see staff for assistance)

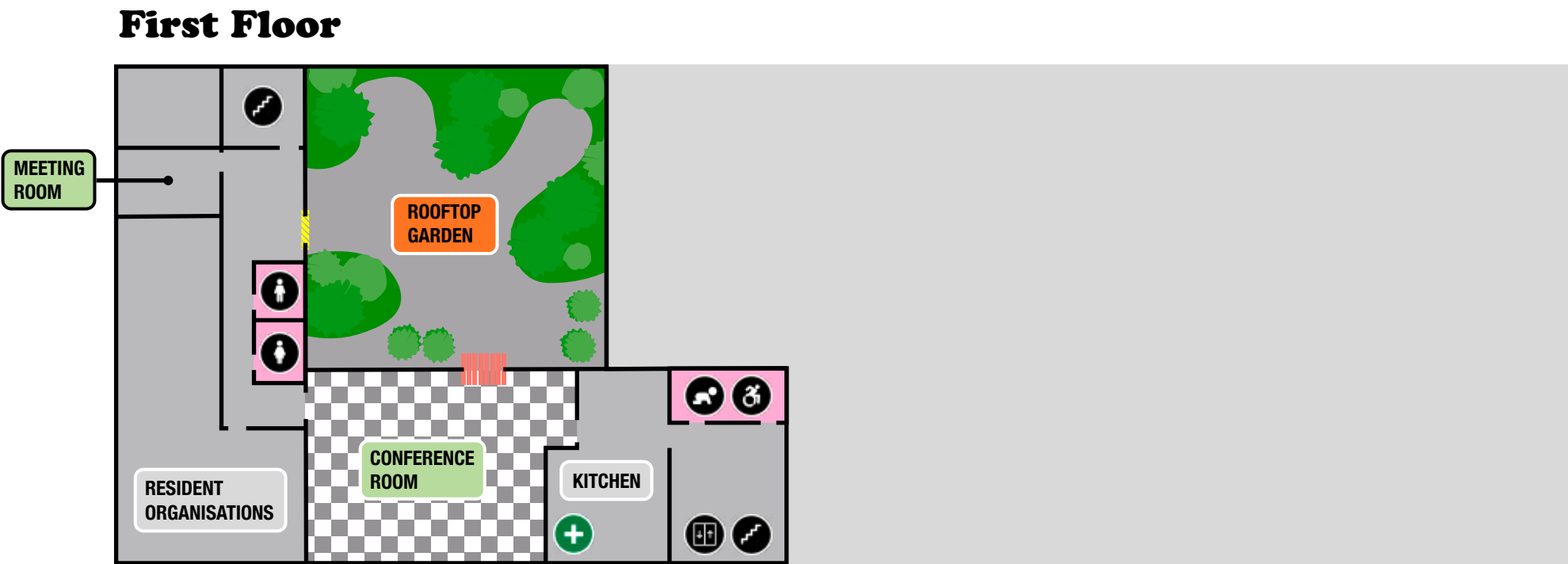
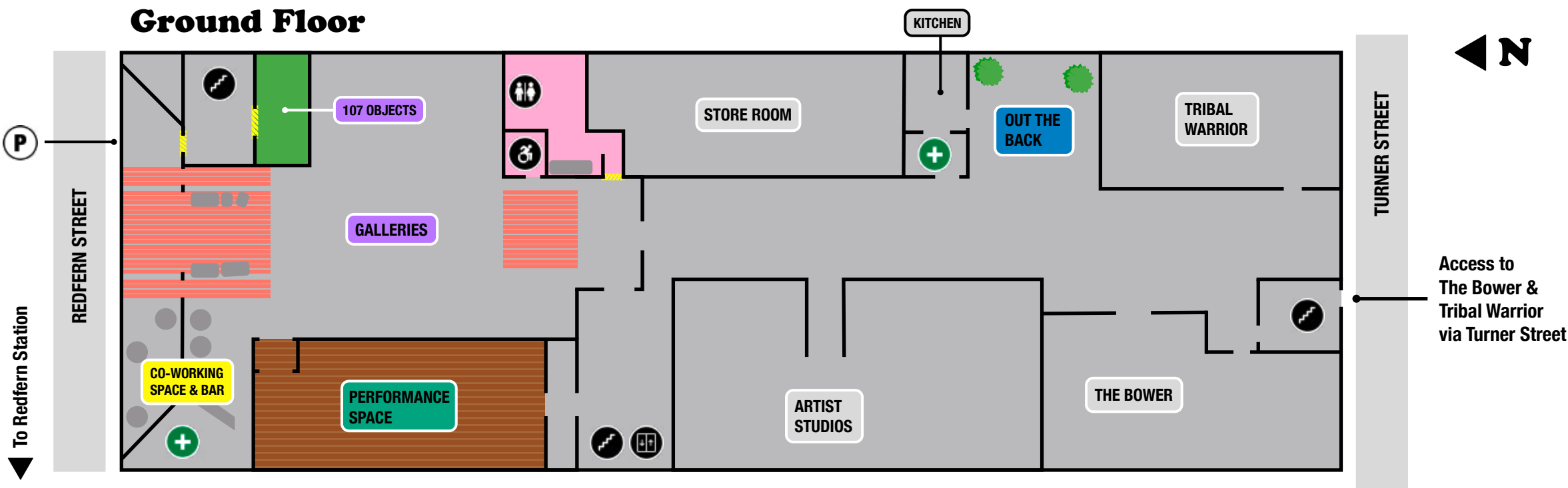

* Please note that the accessible bathrooms on the ground floor are built to an older standard. Some visitors may prefer to use the bathrooms on the first floor.

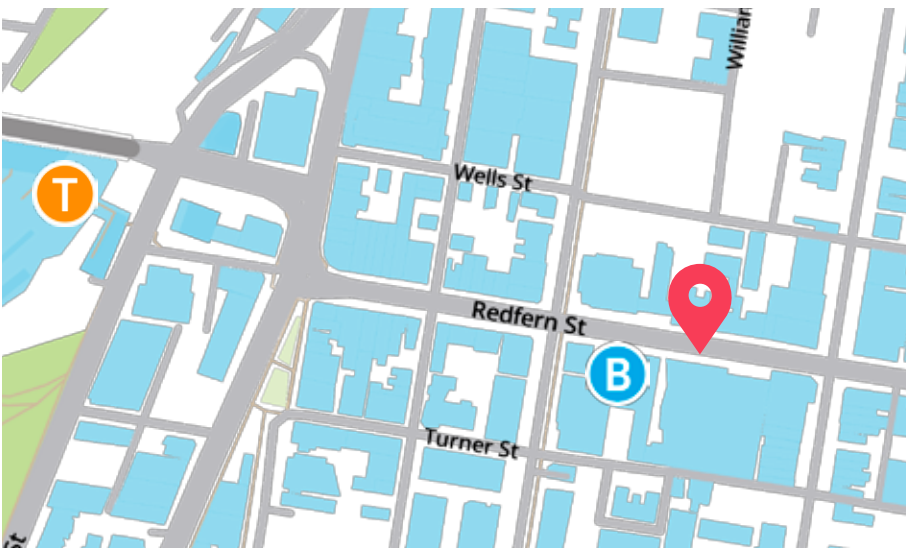

Getting here

T 8 minute walk from Redfern Station
Platform 6 accessible via lift

B Catch the 308, 309 or 310 from Central Station

P Accessible parking space located at front of building

Walking here

From the station: cross 4 intersections; gentle slope.

From the bus stop: no intersections; gentle slope.

Sensory cues

107 Redfern Street is generally low-moderate light and brightness.

What's On?

Visit our website, 107.org.au, to see the full program of events and exhibitions.

Did you know?

107 Projects is a registered charity. We self-fund 72% of our income, with the rest coming from grants and charitable donations. Find out more at 107.org.au/donate.

